



# Alameda

2,180 Square Feet  
BD:5 BA:3GA:3  
Community: Trails at El Cerro



Mediterranean



Tuscan



Garage Orientation: Left    Right

- ☐ Home is complete and accepted as built.\_\_\_\_\_
- ☐ Home construction is in process, buyer accepts all option locations.\_\_\_\_\_

Scan for all  
options and  
upgrades







# Alameda

2,180 Square Feet

BD:5 BA:3GA:3

Community: Trails at El Cerro

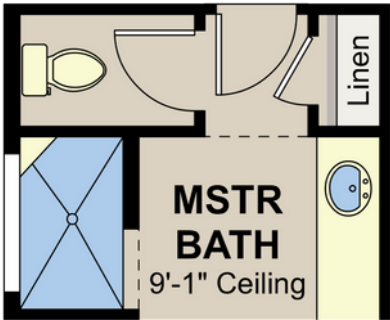

**OPT. DOOR AT MASTER BATH**

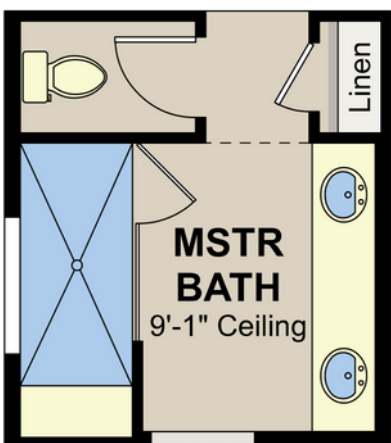

**OPT. DELUXE GLASS SHOWER**

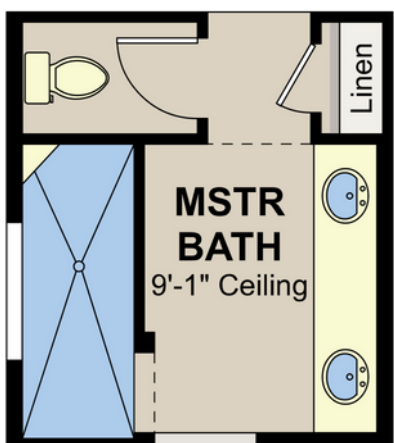

**OPT. DELUXE TILE SHOWER**



**OPT. GUEST SUITE ILO BEDROOM 4 & STUDY**

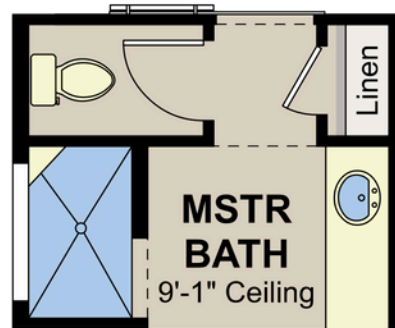

**OPT. BARN DOOR AT MASTER BATH**

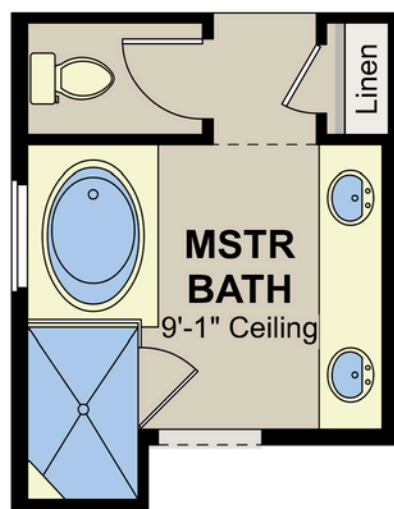

**OPT. TUB W/ GLASS SHOWER**

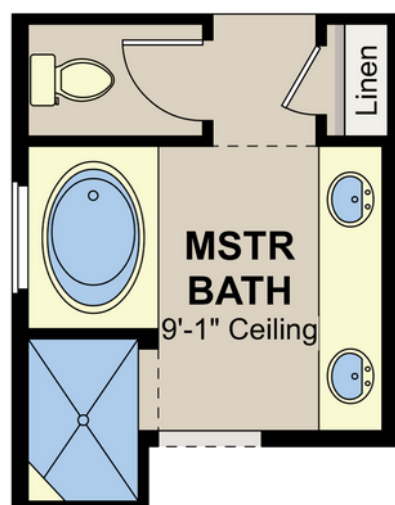

**OPT. TUB W/ TILE SHOWER**

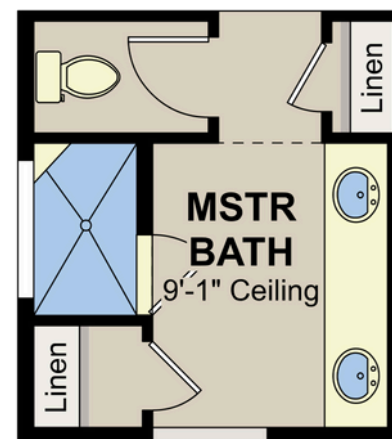

**OPT. GLASS DOOR AT SHOWER**

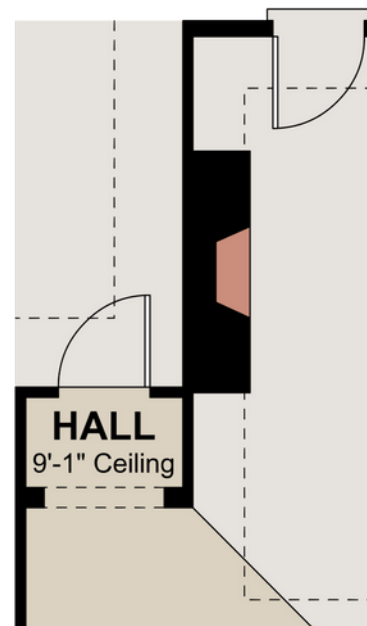

**OPT. FIREPLACE**

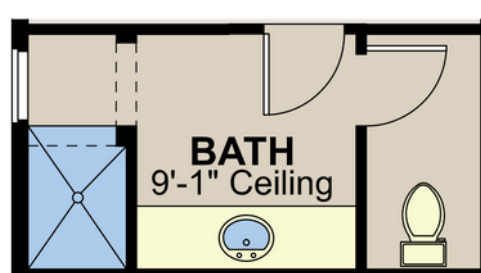

**OPT. DOOR AT GUEST SUITE**

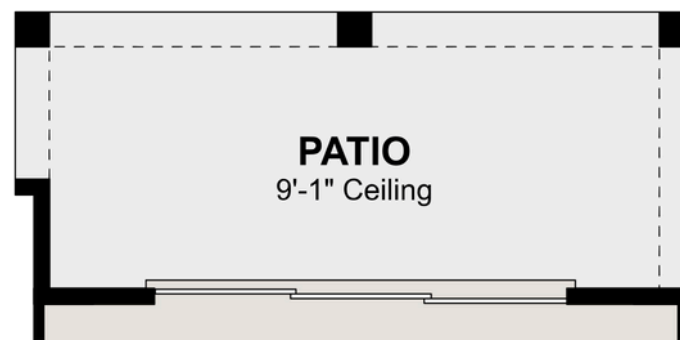

**OPT. STACKING DOOR ILO STANDARD DOOR**

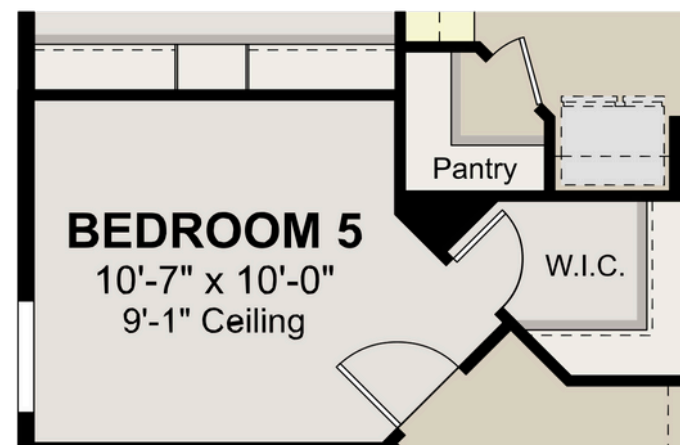

**OPT. BEDROOM 5 ILO STUDY**

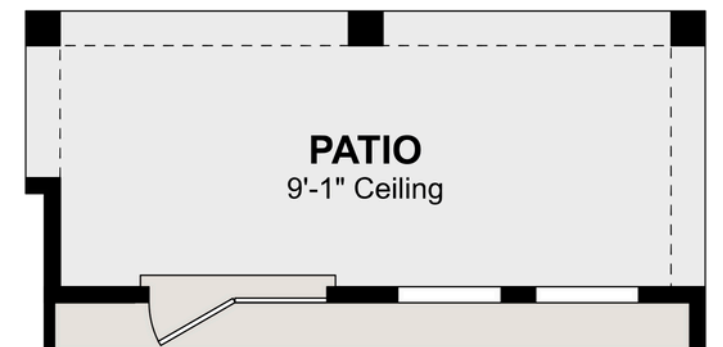

**OPT. CENTER HINGE ILO STANDARD DOOR**

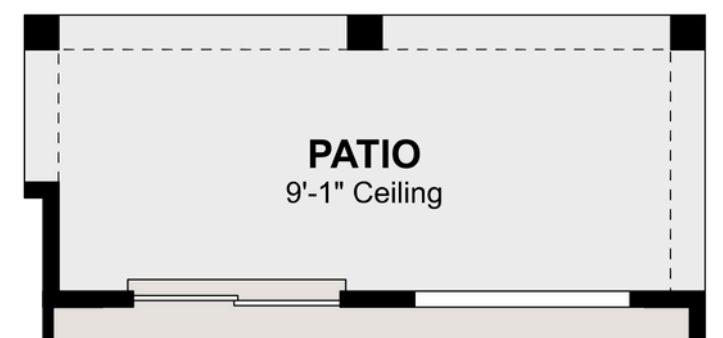

**OPT. SLIDING GLASS DOOR ILO STANDARD DOOR**

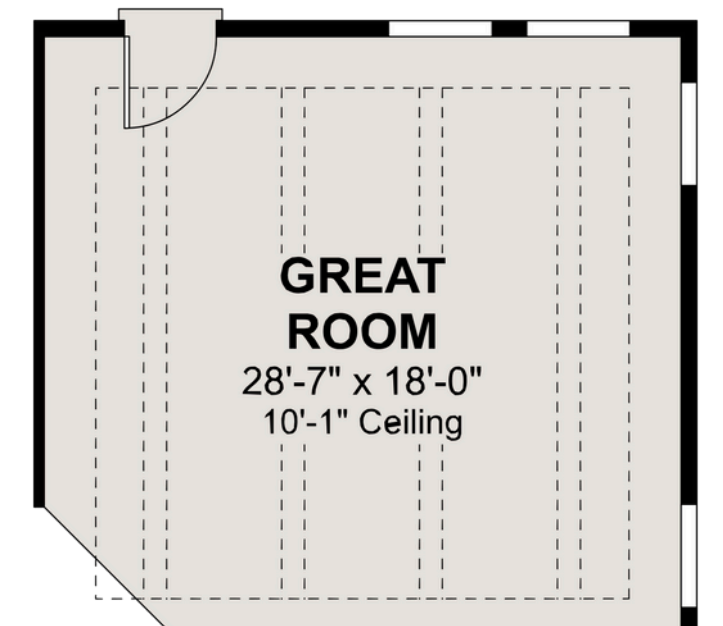

**OPT. CEILING BEAM TREATMENT**

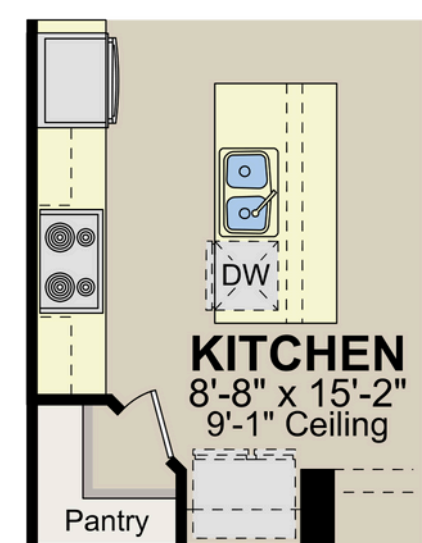

**OPT. GOURMET KITCHEN**

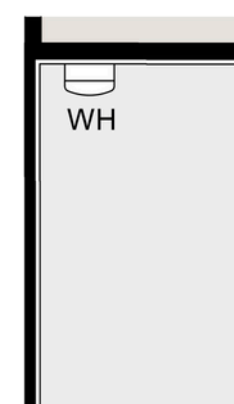

**OPT. TANKLESS WATER HEATER**



**OPT. LAUNDRY CABINETS**